

4-Drawer Short Anesthesia Cart (USGKA-3369-LTG)

 waterloohealthcare.com/product/4-drawer-short-usgka-3369-ltg













Waterloo anesthesia carts have been widely used in the OR for decades. With a variety of organizing accessories and drawer trays, anesthesiologists have critical supplies at their fingertips.

KEY FEATURES:

- Variety of locking options available including dual-credential/auto-relocking controlled substance drawer
- Adjustable metal dividers included in each drawer
- Dual pull out shelves, doubling your work surface
- Universal mounting system allowing flexibility when configuring accessories

SKU: USGKA-3369-LTG Category: [Anesthesia Carts: The Best Carts for Your Medical Facility](#)





SPECIFICATIONS

Frame Type: ALUMINUM STANDARD
Frame Size: SHORT
Dimensions: 29"w x 24.5"d x 36"h

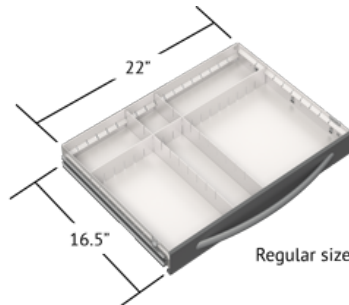
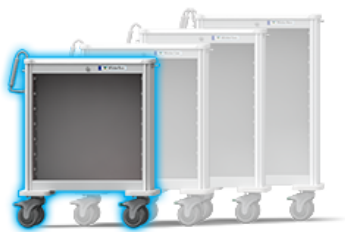
Drawer Dimensions: 22"w x 16.5"d

Drawer Height: 3-3-6-9



3"		2 drawers
6"		1 drawer
9"		1 drawer
12"		

Frame Color: LIGHT GRAY



Drawer Color: LIGHT GRAY



Lock System: KEY LOCK

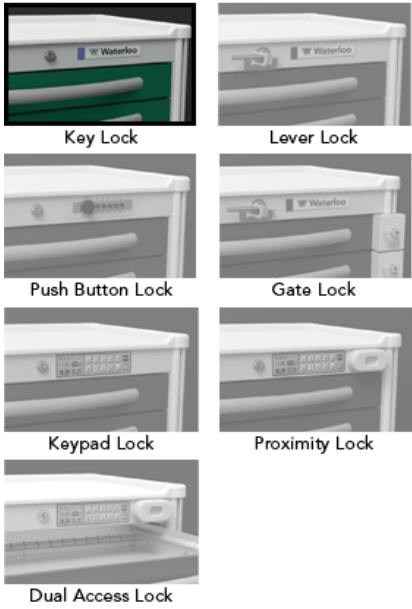

Top: REMOVABLE PLASTIC



Bumpers: STABILIZER BASE

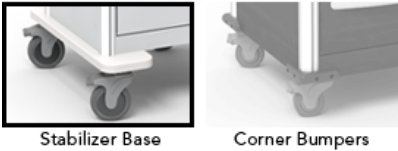

Casters: 5" STANDARD

